

Quick guide for Oticon Opn & Oticon ON App

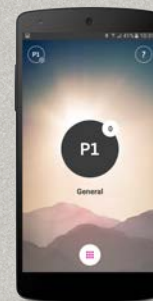

oticon
PEOPLE FIRST

Introduction

This is a detailed guide to the use of Oticon Opn™ and the Oticon ON App for Android phones.

- How to pair Oticon Opn hearing aids with an Android™ phone
- How to use the Oticon ON App

What's new in version

1.4

Adjust left and right volume independently	8
Adjust tinnitus sounds (if supported by hearing aid)	9
New section: Make the most of it	15
Log for an overview of recent events	16
Playback of last hearing aid notification (through event log) ...	16
More background images for main screen	16

 Please note that the Android version of the ON App does not enable users to stream phone calls or audio directly from Android phones to Oticon Opn hearing aids. This technology is not yet available on Android phones.

Please visit www.oticon.ca/connectivity for more details on compatibility, or see the description for Oticon ON App on the App Store and Google Play™.

Table of Contents

4		Install Oticon ON App
6		First time use
7		Home screen functions
8		Select program/program settings/ volume and mute
10		Listening to the TV
12		Connecting to the Internet/IFTTT
14		Secondary functions



Installing the Oticon ON App



Find the Play Store® icon

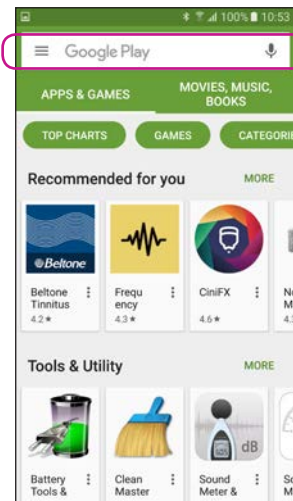

Select the search bar

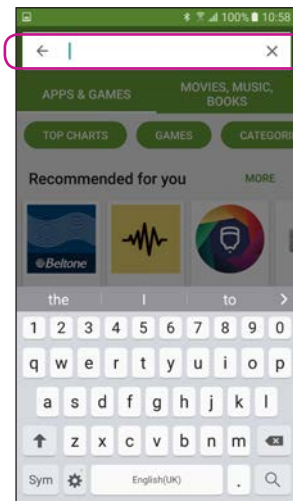

Type "Oticon" into the search bar

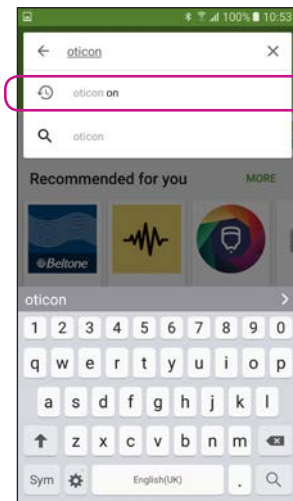

Select the Oticon ON App

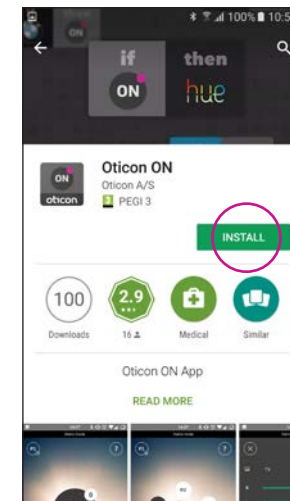

Tap the INSTALL icon

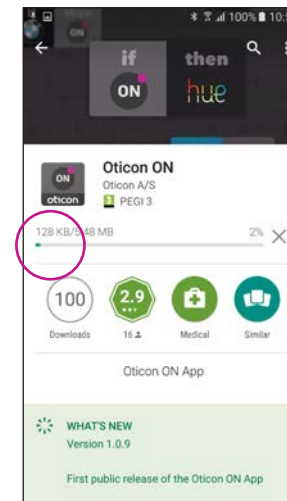

Wait for the app to install

Starting to use the app

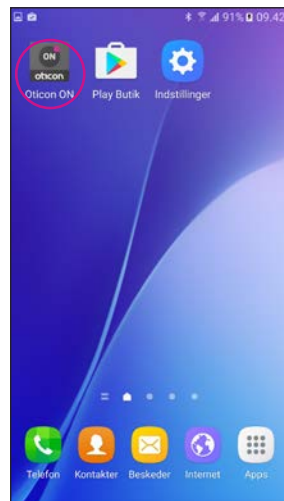

Start the Oticon ON App

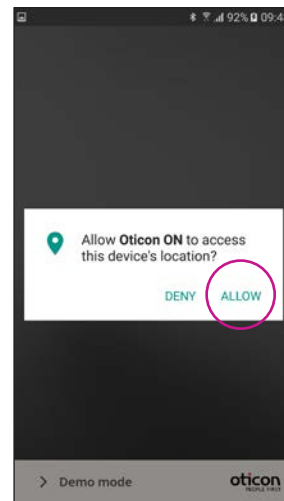

Allow access to phone information

The first time you start the app, allow it to access the phone's location and send you notifications, for the best possible functionality.

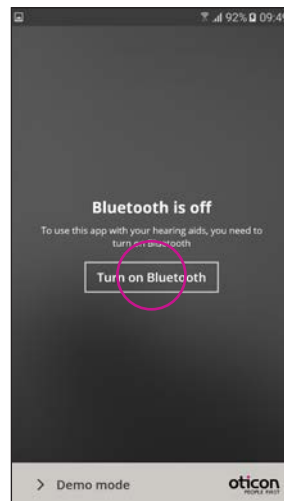

Ensure Bluetooth is switched on

If Bluetooth is switched off on your phone, it will automatically show you this message. Press "Turn on Bluetooth" and continue.

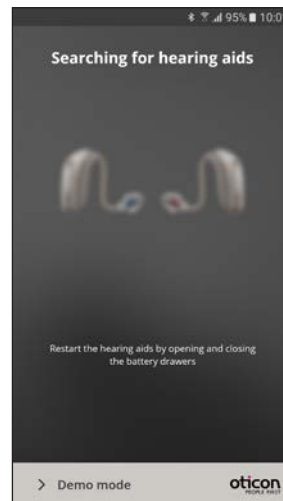

Search for your hearing aids

Your phone will connect to your hearing aids when you start the Oticon ON App. If it can't find your hearing aids, restart them by opening and closing their battery drawers.



Connect to your hearing aids

Select your hearing aids by pressing the "Pair" button. If someone else's hearing aids appear, try to search for your hearing aids again.



Wait for the app to connect

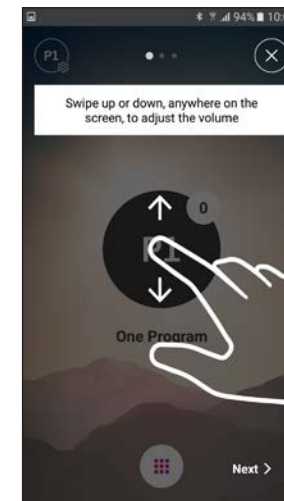

Follow the brief tutorial

The first time you start the app, it presents you with a short overview of how you can control it.

Selecting program/program settings/volume and mute

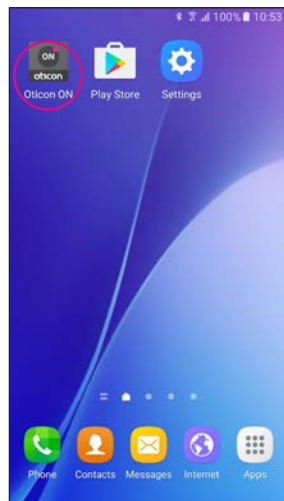

Start the Oticon ON App

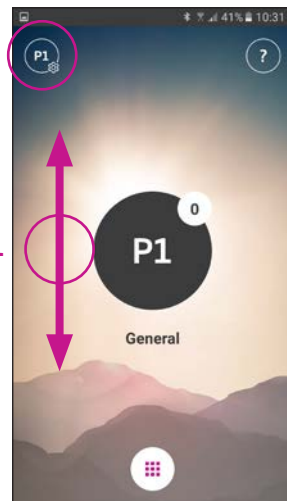

Control the volume

The app shows the current volume in the small white circle on the top right of the black program indicator.

To adjust the volume, simply swipe your finger up or down anywhere on the screen (1).

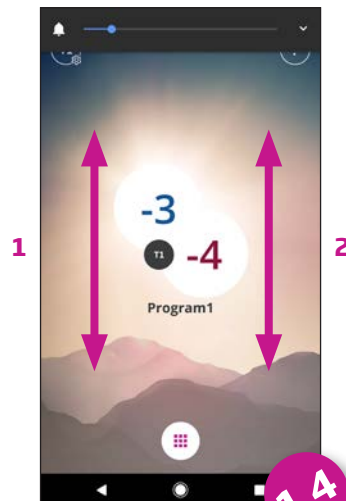

L and R volume

If enabled (see settings) swiping left side (1) will adjust left hearing aid, swiping right side (2) will adjust right side. Swiping in the middle will adjust left and right.



Select program

Touch the black program indicator to open the program selector (1). Select a program (2).

Note: the available programs are determined by your hearing care professional.

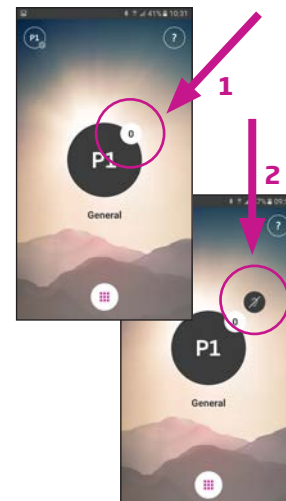

Mute hearing aids

Briefly touch the white volume indicator to mute your hearing aids (1).

Un-mute your hearing aids again by adjusting the volume or touching the mute indicator (2).

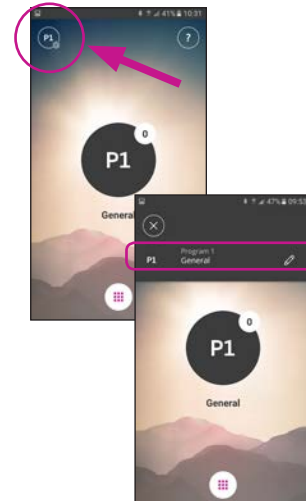

Secondary functions

Press the settings indicator to access the secondary functions related to the active program.

Modify program label

Touch the current label and type the name you want to call it.

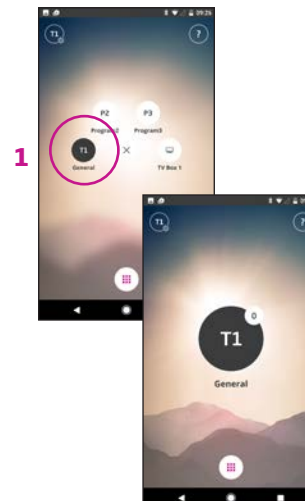

Select Program with relief sounds

If available, programs with Tinnitus relief sounds are named T1 etc. (1).

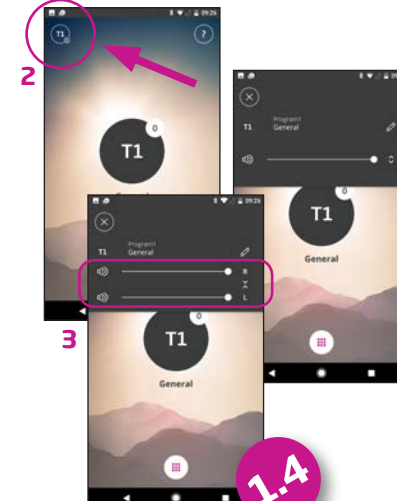

Adjust Tinnitus relief sounds

The level/volume of the Tinnitus relief sounds can be adjusted through the secondary functions (2).

The levels can be adjusted independently left and right (3).

Listening to the TV (requires TV Adapter 3.0)



Select program

Touch the black program indicator to open the program selector (1).

Select the TV program (2).

Note: the available programs are determined by your hearing care professional.



Mute your hearing aids

Briefly touch the white volume indicator to mute the sound from the hearing aids (1).

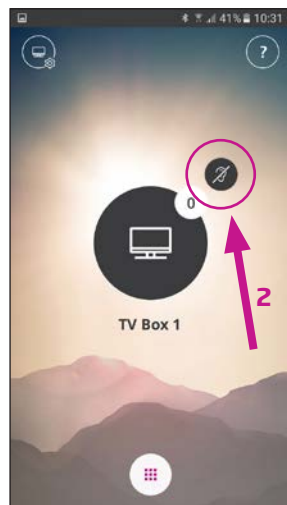

Un-mute your hearing aids

You can un-mute your hearing aids by adjusting the volume or touching the mute indicator (2).

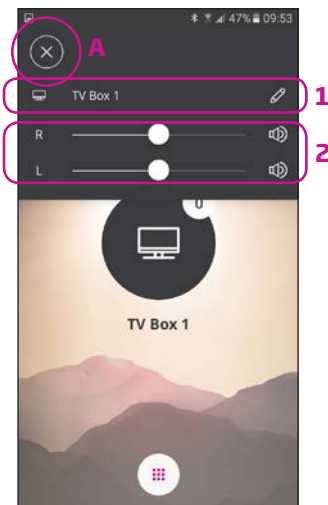

Secondary functions

Touch the settings indicator (A) to access the secondary functions related to the active TV program.

Here, you can change the name of the TV program (1) or regulate the level of the streamed TV/audio signal (2).

Connecting to the Internet/IFTTT

Introduction

You can connect your Oticon hearing aids to the Internet through the Oticon ON App and the IFTTT (If This Then That) service.

By doing this you will be able to have different events – such as turning on the lights – synchronized with turning on your hearing aids in the morning. Or, a text message alert could be sent if your hearing aid battery is low.

The possibilities are endless!

Please visit ON.Oticon.com for details on what you can do and how it works.

Here, you can also find more details about how to set up and manage your IFTTT accounts.

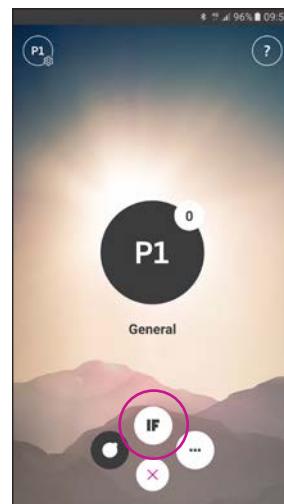

Connect to IFTTT
Select the IFTTT main feature

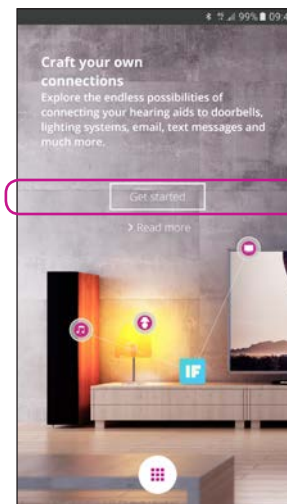

First time set-up
Select Get started

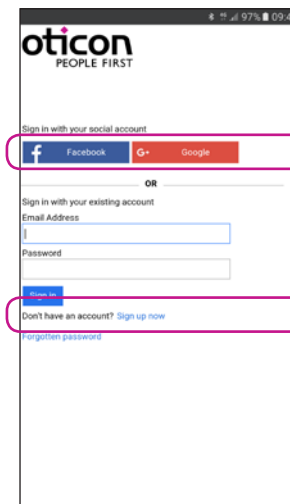

Select Sign up now (1) or use an existing Facebook™ or Google™ account (2)

If you sign up from the app, you will receive an e-mail with a code, which you will need to enter to confirm your login

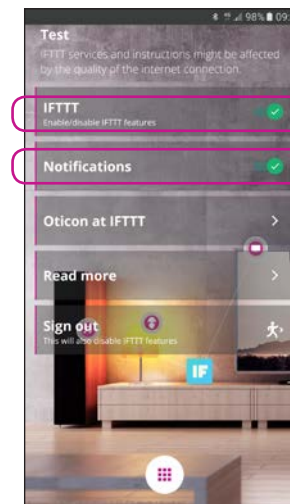

IFTTT
If the IFTTT option is turned off, IFTTT events are not active

Notifications
If OFF then no notifications can be seen on the notification screen on the phone

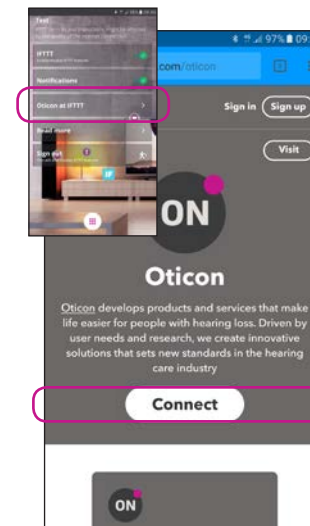

Oticon at IFTTT
A direct link to the Oticon channel on IFTTT

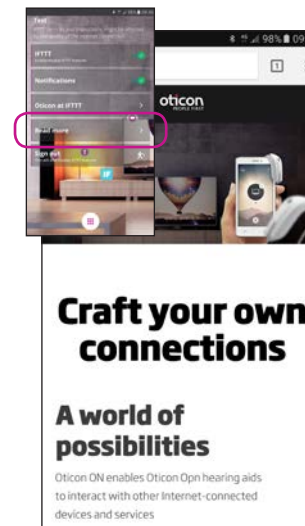

Read More
A direct link to on.oticon.com, where you can find much more information about ON and IFTTT

Secondary functions

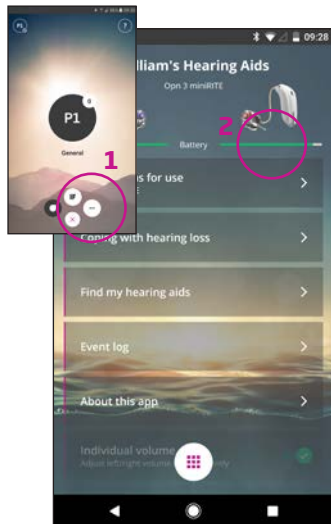

Settings

Press the settings icon to access the secondary features of the Oticon ON App (1)

Battery status

A visual presentation of the battery status of both the left and the right hearing aid (2)

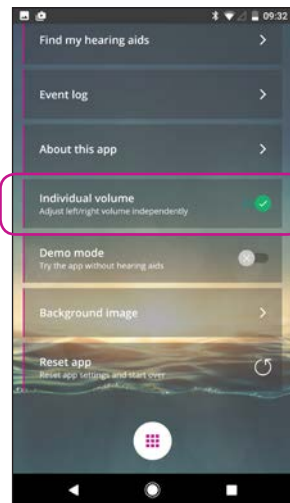

Individual volume

This option enables separate volume control for left and right hearing aid.

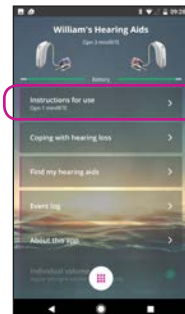

Instructions for use

The first time the app connects to the Internet, it will automatically download the instructions for your specific hearing aid

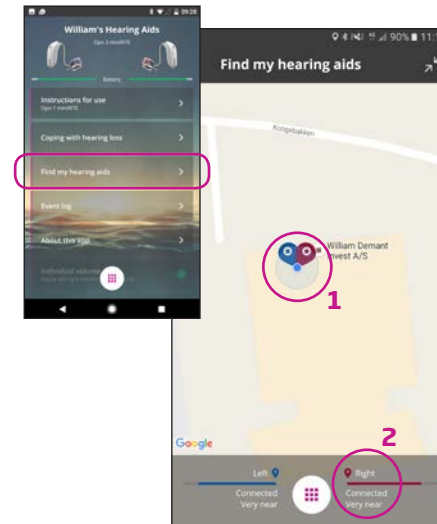
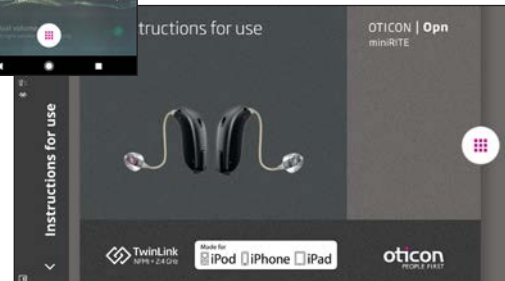

Find my hearing aids

The map will show where your hearing aids were last connected to the phone (1). If close by, the Proximity bars will indicate how close you are to your hearing aids (2).

Note: If you go out of range/lose connection with your hearing aids, the red/blue markers on the map will show the last known location of the hearing aids.

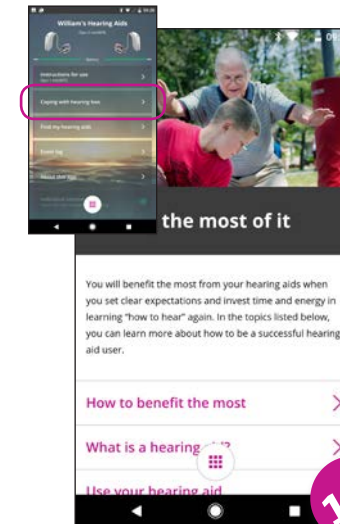

Coping with hearing loss

The app includes information and advice on how to make the most out of living with a hearing aid.

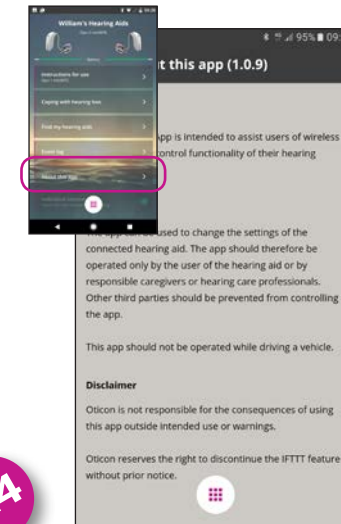

About the app

Warnings and disclaimers

Secondary functions

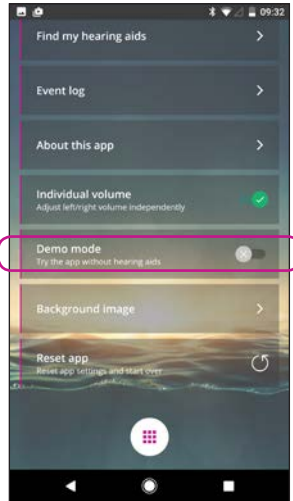

Demo mode

This option enables you to try the app without having your hearing aids connected to the phone.

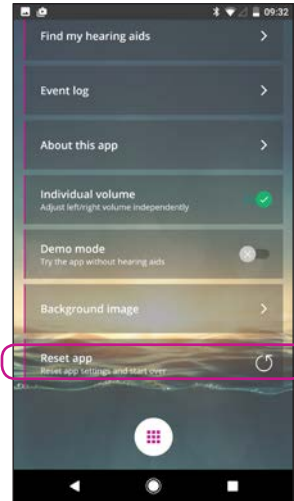

Reset app

Resetting the app will restore all user defined settings to factory settings.

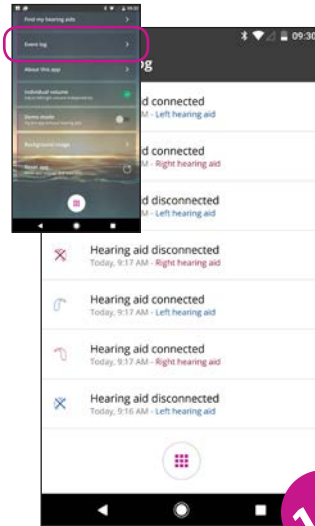

Event log

The app includes an overview of recent events registered. If e.g. a warning is heard – it can be found, and replayed from the event log.

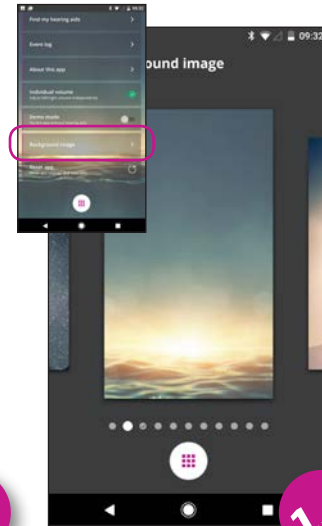

Background image

The background image on the main view can be customized.

1.4

1.4

Manufacturer:

Oticon A/S
Kongebakken 9
DK-2765 Smørum
Denmark
www.oticon.global

Local Manufacturer**& Distributor:**

Oticon Canada
1-6950 Creditview Road
Mississauga, ON L5N 0A6
www.oticon.ca

