

OTICON | **Opn**

## Quick guide

Re-pairing Oticon Opn™ with accessories  
after firmware updates

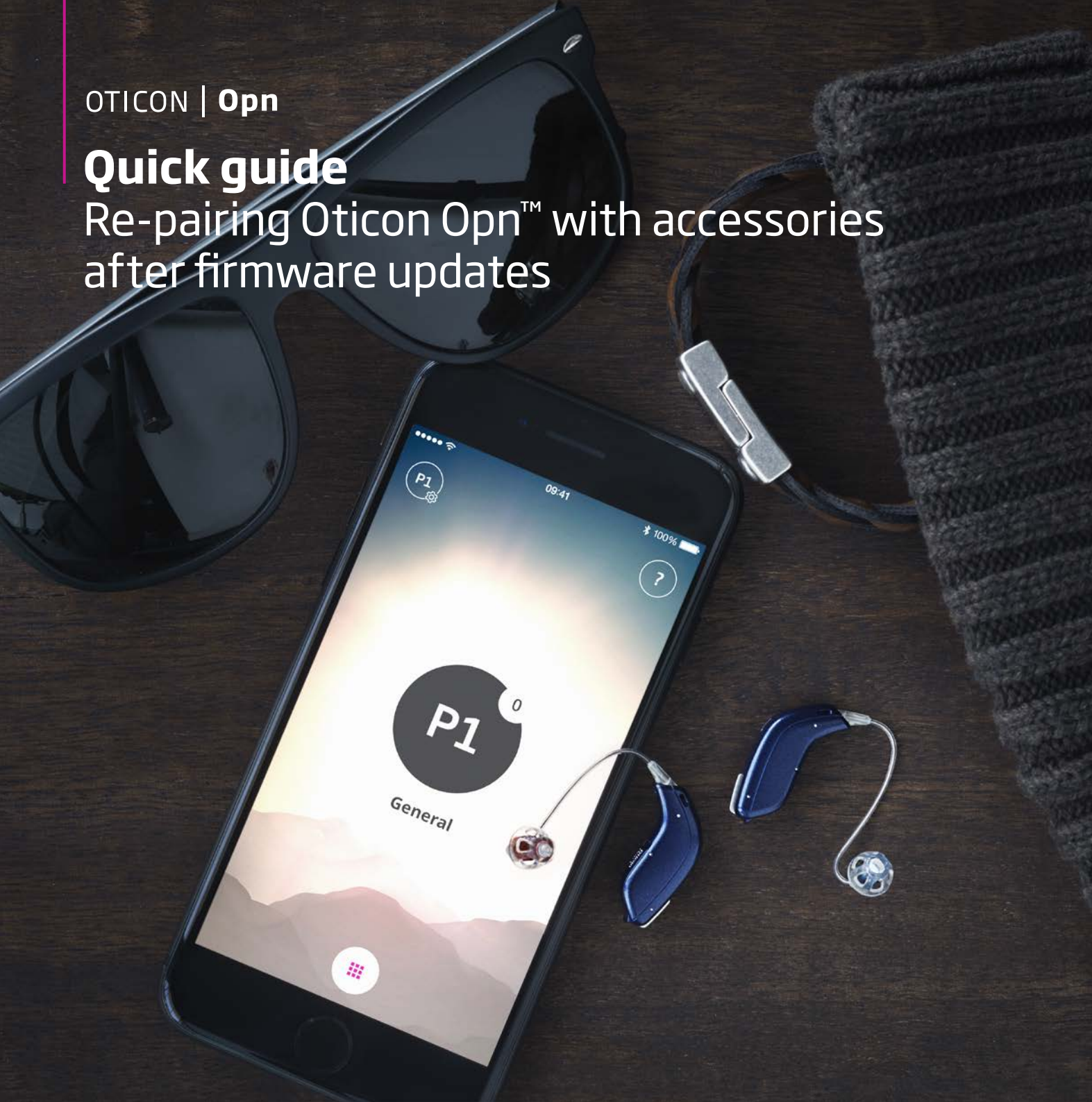

**oticon**  
PEOPLE FIRST



## Introduction

After upgrading Oticon Opn firmware, it is necessary to re-pair the instruments with relevant accessories.

This short guide shows you how to re-pair Oticon Opn with different types of accessories.



Please visit [www.oticon.ca/connectivity](http://www.oticon.ca/connectivity) for more details on compatibility, or see the description of the Oticon ON App on the App Store® and Google Play™.

Apple, the Apple logo, iPhone, iPad, iPod touch, and Apple Watch are trademarks of Apple Inc., registered in the U.S. and other countries. App Store is a service mark of Apple Inc. Android, Google Play, and the Google Play logo are trademarks of Google Inc.

## Table of contents

<b>Basic Remote 3.0</b>	<b>3</b>
Prepare remote control for re-pairing	3
Put the hearing aids in pairing mode	3
Pair the remote control with the hearing aids	4
<b>TV Adapter 3.0</b>	<b>5</b>
<b>iPhone</b>	<b>6</b>
Remove the "old pairing" from iPhone®	6
Pair the hearing aids with iPhone	8
<b>Android™</b>	<b>10</b>
Remove the "old" pairing from the Android device	10
Pair the hearing aids with the Android device	12
<b>Notes</b>	<b>14</b>

# Basic Remote 3.0

## 1. Prepare remote control for pairing



**Press and hold all buttons for 5 seconds.**

The status LED will flash green twice.

The status LED will then glow green for about 10 seconds to confirm the remote is ready for pairing.

## 2. Put the hearing aids in pairing mode

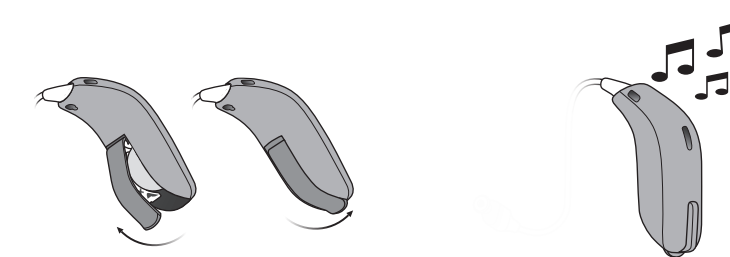

**Ensure that you have good batteries in the hearing aids.** Open the battery drawers of both hearing aids. Wait about five seconds and close the battery doors again.

Wait for about 10 seconds - until the hearing aids are fully turned on and the power-on-jingle has been played.

The hearing aids will remain in pairing mode for 3 minutes.

## Basic Remote 3.0

### 3. Pair the remote control with the hearing aids

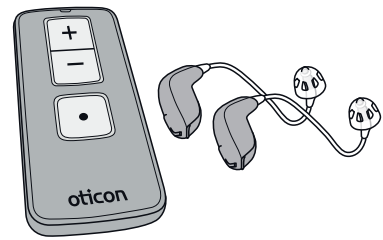

Place both hearing aids within 20 centimetres of the remote control.

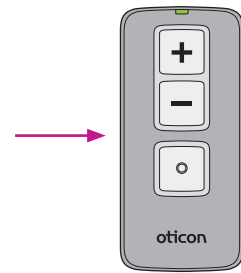

Briefly press any key on the remote control to make it automatically pair with the hearing aids.

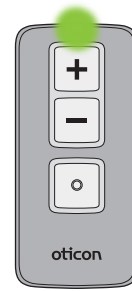

When pairing is completed, the status light glows green for about 10 seconds.

## TV Adapter 3.0

### 1. Pair the TV adapter with the hearing aids (no need to clear previous pairings)

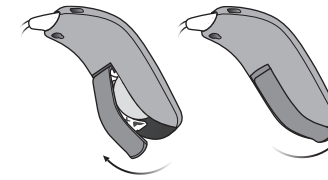

Ensure that you have good batteries in the hearing aids.

Open the battery drawers of both hearing aids. Wait about five seconds and close the battery doors again.



Wait about 10 seconds, until the hearing aids are fully turned on and the power-on-jingle has been played.

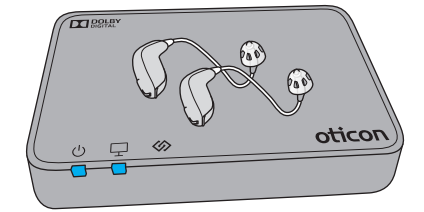

Place both hearing aids close to or on top of the TV Adapter.

Pairing is completed when the power indicator and the TV indicator glows blue for about 30 seconds.

TV Adapter	Description
	Pairing completed



# iPhone

## 1. Remove the "old pairing" from iPhone

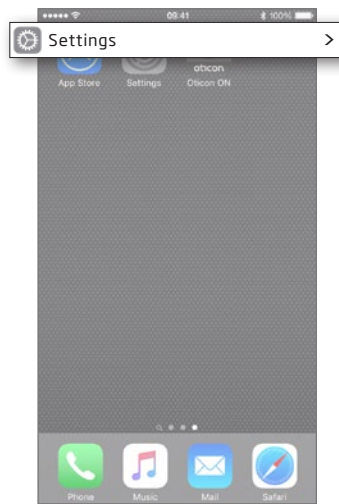

**Enter Settings**  
Find the Settings icon on iPhone.

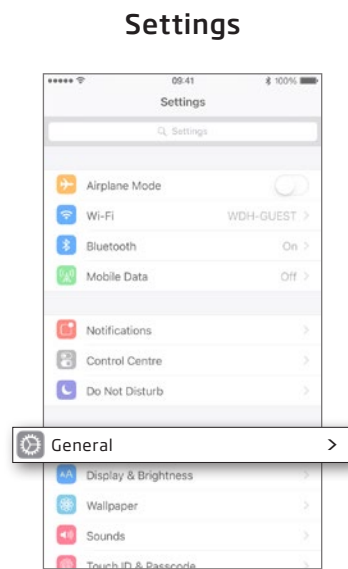

**Select General**

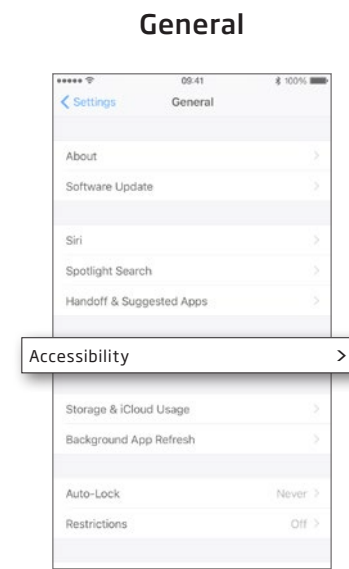

**Select Accessibility**

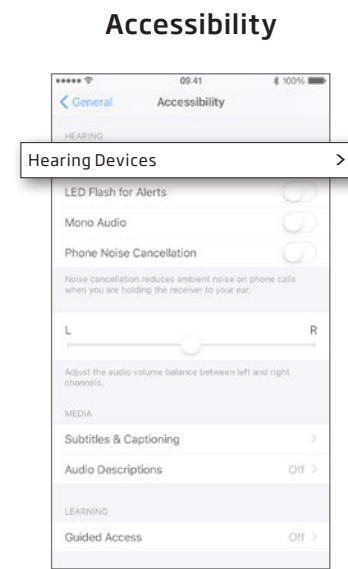

**Select Hearing Devices**

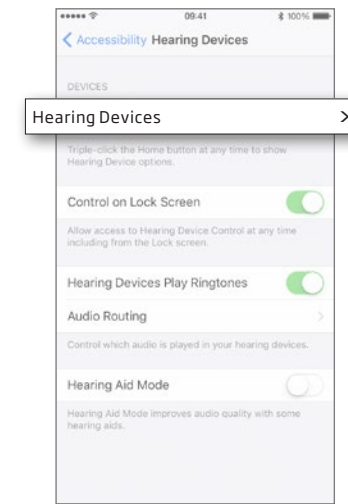

**Select the hearing aids you would like to remove.**

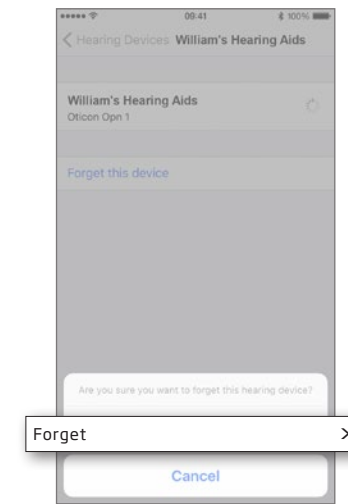

**Select Forget**

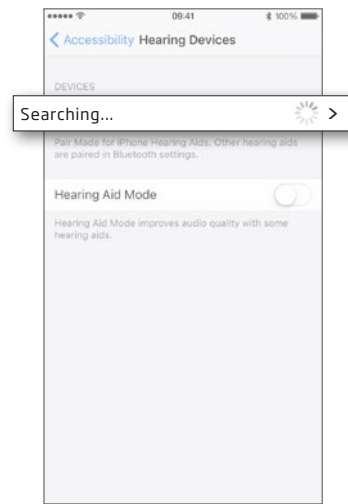

**iPhone will now search for new hearing aids.**



**Turn bluetooth off and back on before pairing again.**

## 2. Pair the hearing aids with iPhone

Settings

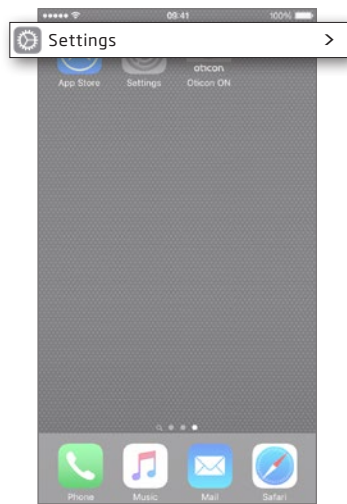

**Enter Settings**  
Find the Settings icon on iPhone.

General

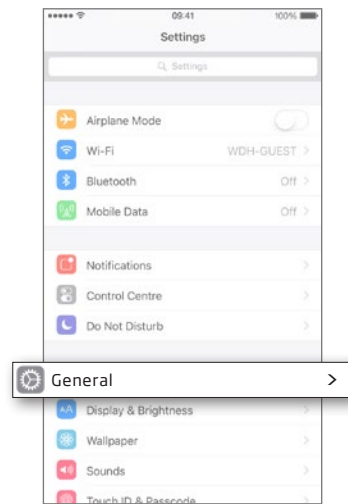

**Select General**

Accessibility

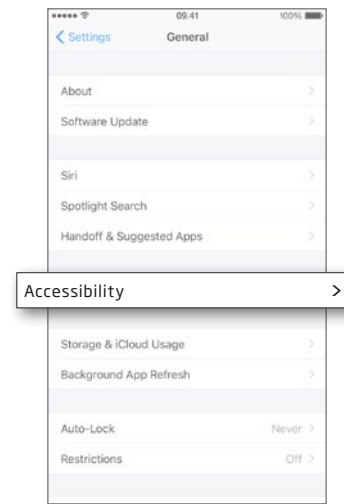

**Select Accessibility**

Hearing Devices

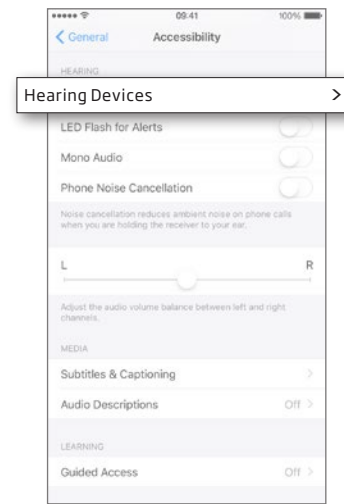

**Select Hearing Devices**

Bluetooth On

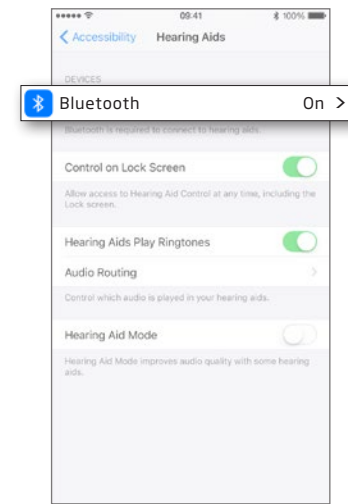

**Ensure Bluetooth is on**

Searching...

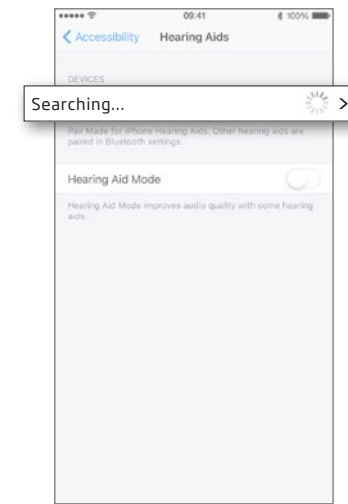

iPhone will now search for hearing aids.

Open and then close the battery door on the instruments so iPhone can recognize them.

William's Hearing Aids Oticon Opn

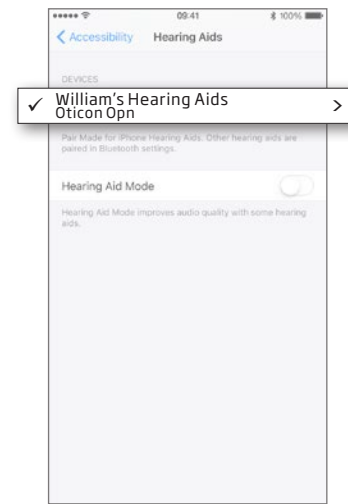

Select the hearing aids when they become available.

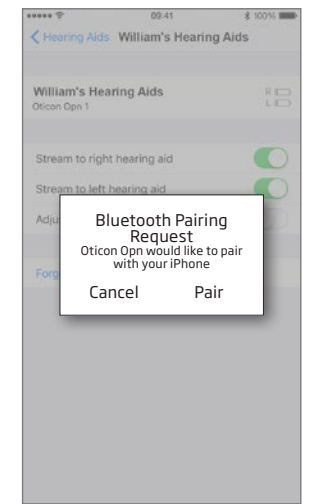

Confirm the Bluetooth pairing request once for each hearing aid.



# Android device

## ⚠ App version 1.0.9

### 1. Remove the "old" pairing from the Android device

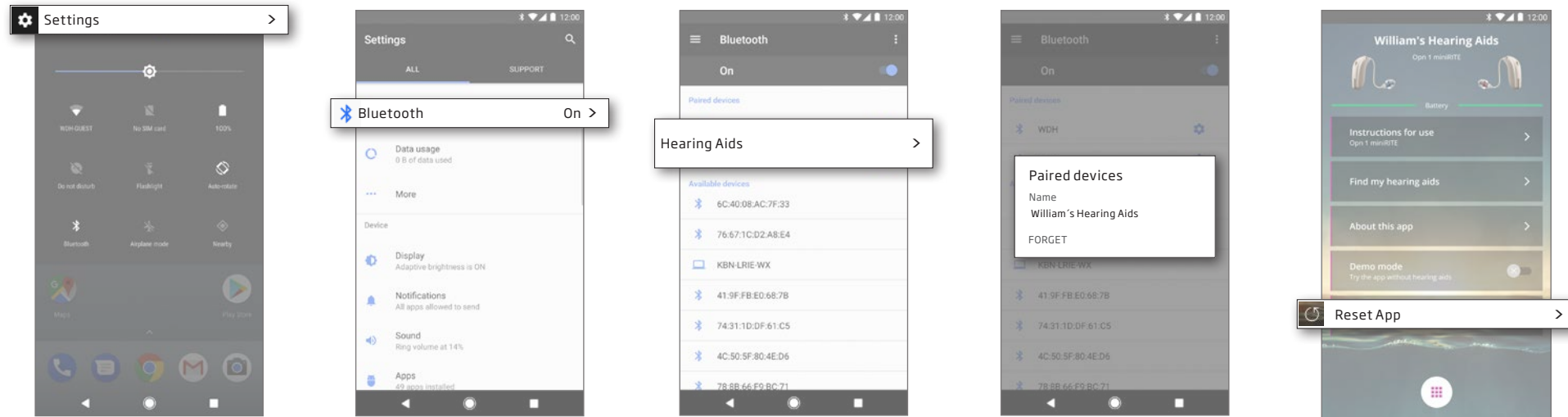

Enter Settings

Ensure Bluetooth is on

Select Hearing Aids

Select Forget

Reset App

## ⚠ App version 1.0.10 and later

### 1. Remove the "old" pairing from Android device

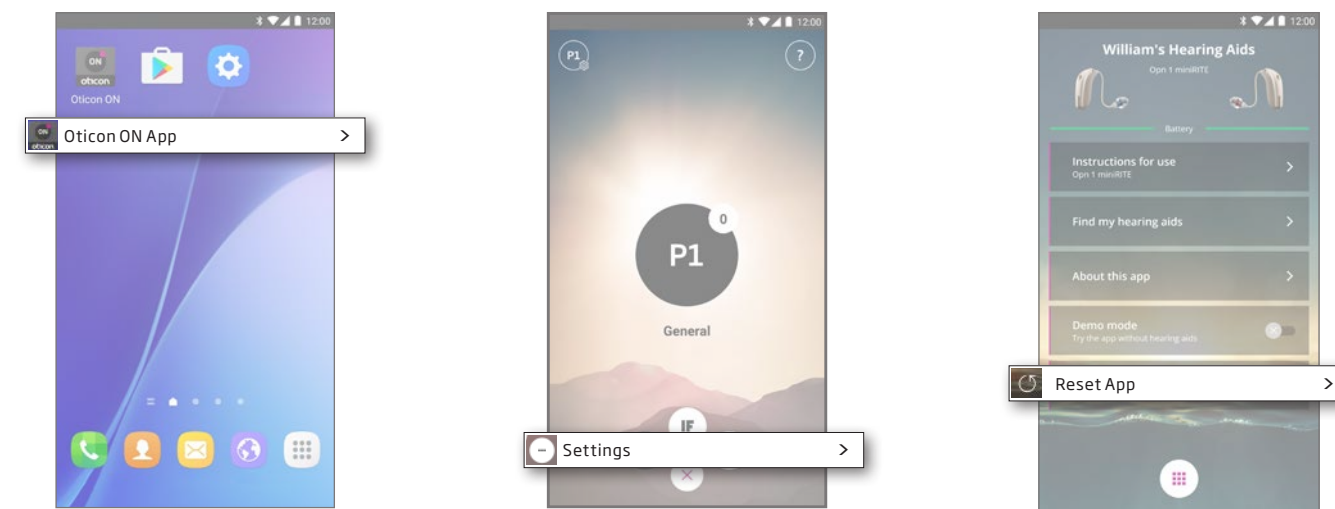

Start the Oticon ON App

Enter Settings

Press the Settings icon to access the secondary features of the Oticon ON App.

Reset App

Resetting the app will also remove the old pairing.

## 2. Pair the hearing aids with the Android device



**Start the Oticon ON App**

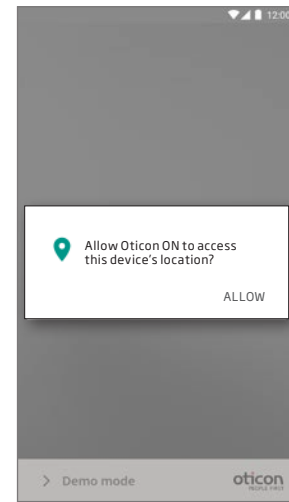

**Allow access to device information**

The first time you start the app, allow it to access the device's location. This ensures the best possible functionality.

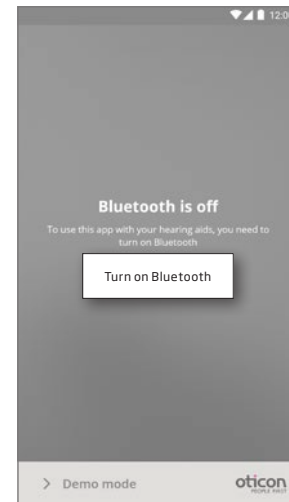

**Ensure Bluetooth is switched on**

If Bluetooth is switched off on your device, it will automatically show you this message. Press "Turn on Bluetooth" and continue.

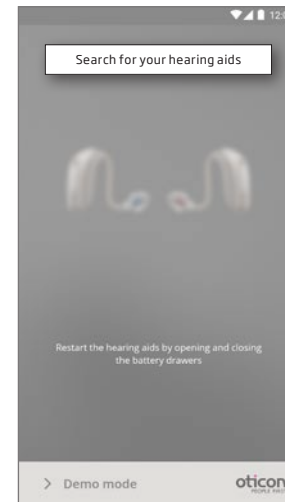

**Search for your hearing aids**

Your device will connect to your hearing aids when you start the Oticon ON App. If it can't find your hearing aids, restart them by opening and closing their battery drawers.

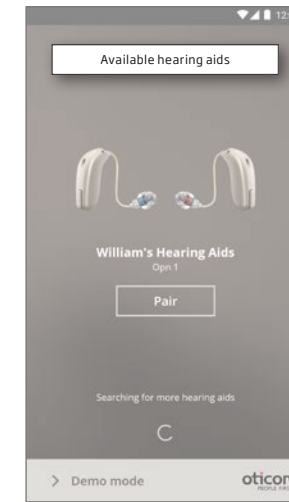

**Connect to your hearing aids**

Select your hearing aids by pressing the "Pair" button. If someone else's hearing aids appear, try to search for your hearing aids again.

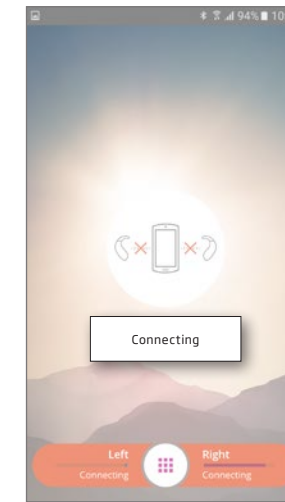

**Wait for the Oticon ON App to connect**

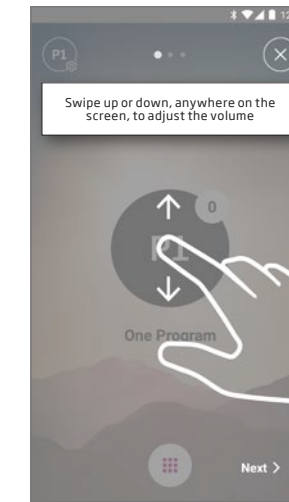

**Follow the brief tutorial**

The first time you start the app, it presents you with a short overview of how you can control it.







**Manufacturer:**  
Oticon A/S  
Kongebakken 9  
DK-2765 Smørum  
Denmark  
[www.oticon.global](http://www.oticon.global)

**Local Manufacturer  
& Distributor:**  
Oticon Canada  
1-6950 Creditview Road  
Mississauga, ON L5N 0A6  
[www.oticon.ca](http://www.oticon.ca)

**oticon**  
PEOPLE FIRST